

LENNOX HEARTH PRODUCTS

Service Replacement Parts List

Models Advantage Optima 2 FS, Optima 3 FS & Optima 3 INS

H0362, H0363, H0364

Freestanding and Insert Pellet Stoves

Model Years: 2002 - 2006

| ITEM NO | PART NO | DESCRIPTION | Stove Model |
|---|----------|---|--------------------|
| Door Parts & Body Components | | | |
| ** | 14650414 | Ash Pan Cover | Optima 2 FS |
| ** | 14750460 | Ash Pan Cover | Optima 3 FS |
| ** | 14750605 | Ash Pan Cover | Optima 3 INS |
| 2 | 14650460 | Door Assembly, Cast Iron Firebox | Optima 2 FS |
| 2 | 14750458 | Door Assembly, Cast Iron Firebox | Optima 3 FS & INS |
| ** | 26M81 | Door Gasket 3/4" Rope (10 Ft.) | Optima 2 FS |
| ** | 61051000 | Door Gasket 1" Rope (7 Ft.) | Optima 3 FS & INS |
| ** | 61057202 | Glass Gasket (5/8" x 1/16" x 10 Ft.) | All |
| ** | H0257 | Center Glass Includes gasket | Optima 2 FS |
| ** | H0258 | Side Glass (order 2 if set is needed), Includes gasket | Optima 2 FS |
| ** | H0254 | Center Glass Includes gasket | Optima 3 FS & INS |
| ** | H0255 | Side Glass (order 2 if set is needed) Includes gasket | Optima 3 FS & INS |
| 5 | 14650446 | Hinge Bracket | Optima 2 FS |
| 6 | 14750700 | Hinge Bracket | Optima 3 FS & INS |
| ** | 13740005 | Hopper Lid Hinge Bracket | Optima 2 FS & 3 FS |
| ** | 11950068 | Hopper Lid Hinge Bracket | Optima 3 INS |
| 3 | 14750406 | Door Knob (knob only, 1 ea.) | All |
| 4 | 14750405 | Door Handle Opener | All |
| 7 | 14650450 | Left Side Panel | Optima 2 FS |
| 8 | 14650451 | Right Side Panel | Optima 2 FS |
| 9 | 14750449 | Left Side Panel | Optima 3 FS |
| 10 | 14750448 | Right Side Panel | Optima 3 FS |
| 11 | 14650456 | Rear Panel | Optima 2 FS |
| 12 | 14750465 | Rear Panel | Optima 3 FS |
| 13 | 14750612 | Left Side Panel | Optima 3 INS |
| 14 | 14750613 | Right Side Panel | Optima 3 INS |
| 15 | 14750617 | Top Panel (hopper lid) | Optima 3 INS |
| 16 | 14650455 | Top Panel (hopper lid) | Optima 2 FS |
| 16 | 14750455 | Top Panel (hopper lid) | Optima 3 FS |
| ** | 12051409 | Control Panel Door Knob (6 per package w/studs) | Optima 3 INS |
| Electrical Parts | | | |
| 17 | 12046300 | Auger Motor, Merkel Korff (Drives pellet feed auger) | All |
| 28 | 12146109 | Room Air Blower, Hard Washer (Convection) | All |
| 27 | 12050011 | Exhaust Blower (Combustion) | All |
| 18 | 16053941 | Control Board | Optima 2 FS |
| 18 | 16052112 | Control Board | Optima 3 FS & INS |
| 19 | 12147705 | High Limit Disc 250 DG (L250-30F,60T21) Set of 3 | All |
| ** | 18150150 | Control Board Fuse, 5 Amp, 250 volt, Fast blow, 12 pk. | All |
| ** | 12055908 | Igniter Fuse 6 Amp, 125 volt, Fast blow, 12 pk. | All |
| ** | 12150213 | Igniter Cartridge w/Fuse, Fastfire, 1 each, 380 W, 3.3 Amps -This replacement kit is for all units with a preinstalled Fastfire Igniter | All |
| 22 | 14750404 | Photoeye Replacement | All |
| 23 | 12058820 | Power Cord with Molded End, Detachable (8 ft.; 52L17) | All |
| 25 | 16050001 | Pressure Switch | All |
| 24 | 16050205 | Wall Thermostat | All |
| 26 | 12050815 | Wiring Harness | All |
| Firebox Parts | | | |
| 29 | 13640028 | Brick Clips | Optima 2 FS |
| 30 | 11750011 | Brick Clip | Optima 3 FS & INS |
| ** | 14750469 | Firebox Baffle | Optima 3 FS & INS |

| | | | |
|--------------------------------|----------|---|--------------------|
| ** | 13650046 | Firebox Baffle | Optima 2 FS |
| 31 | 14650011 | Firebrick 1 pc. | Optima 2 FS |
| 32 | 14750015 | Firebrick Set, 3 pc. | Optima 3 FS & INS |
| 33 | 14650428 | Igniter Tube - Housing | Optima 2 FS |
| 34 | 14750421 | Igniter Tube - Housing | Optima 3 FS & INS |
| 35 | 12158905 | UltraGrate™ | All |
| Auger System Components | | | |
| 40 | 11756300 | Auger Shaft | All |
| 36 | 12051001 | Auger Bumper (Set of 5) | All |
| 37 | 12041300 | Auger Collar & Set Screw (Set of 3) | All |
| 38 | 20950088 | Auger End Plate (flange) (w/nylotron bushing) | All |
| Miscellaneous | | | |
| ** | 14650408 | Ash Pan | Optima 2 FS |
| ** | 14750409 | Ash Pan | Optima 3 FS |
| ** | 14750603 | Ash Pan | Optima 3 INS |
| ** | 12151307 | Damper Rod Set Collar 1/4" (w/set screw) | Optima 2 FS & 3 FS |
| ** | 12151309 | Damper Rod Complete | Optima 2 FS & 3 FS |
| ** | H3455 | Damper Rod Complete | Optima 3 INS |
| ** | 11750004 | Damper Rod Knob (6 per pack) | All |
| 41 | 15050058 | Photoeye Filter (Amber Lens) | All |
| 42 | 61050003 | Auger Flange Gasket, 5pc. | All |
| 43 | 61050005 | Exhaust blower Gasket, 5pc. | All |
| ** | 14650060 | Photoeye Gasket | Optima 2 FS |
| ** | H3524 | Photoeye Gasket | Optima 3 FS & INS |
| 45 | 61050016 | Quick Disconnect Gasket 5pc. | All |
| 44 | 61057203 | Room air blower Gasket 5pc. | All |
| ** | H0464 | Log Set | Optima 3 FS & INS |
| ** | H0244 | Log Set | Optima 2 FS |
| 47 | 12050093 | 3" Quick Disconnect Vent Side | All |
| 39 | 17150009 | Scraper Rod Kit (includes rod, collar and knob) | All |
| 46 | 12055500 | Grate Scraper Tool | All |

** = No picture

Right & Left are referred to as viewed from front of unit.

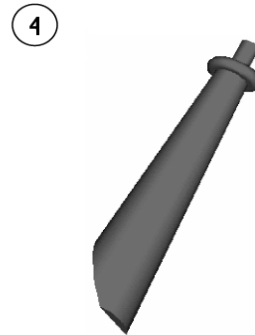
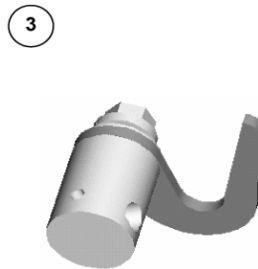
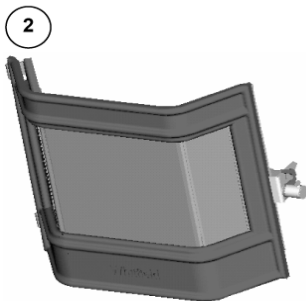

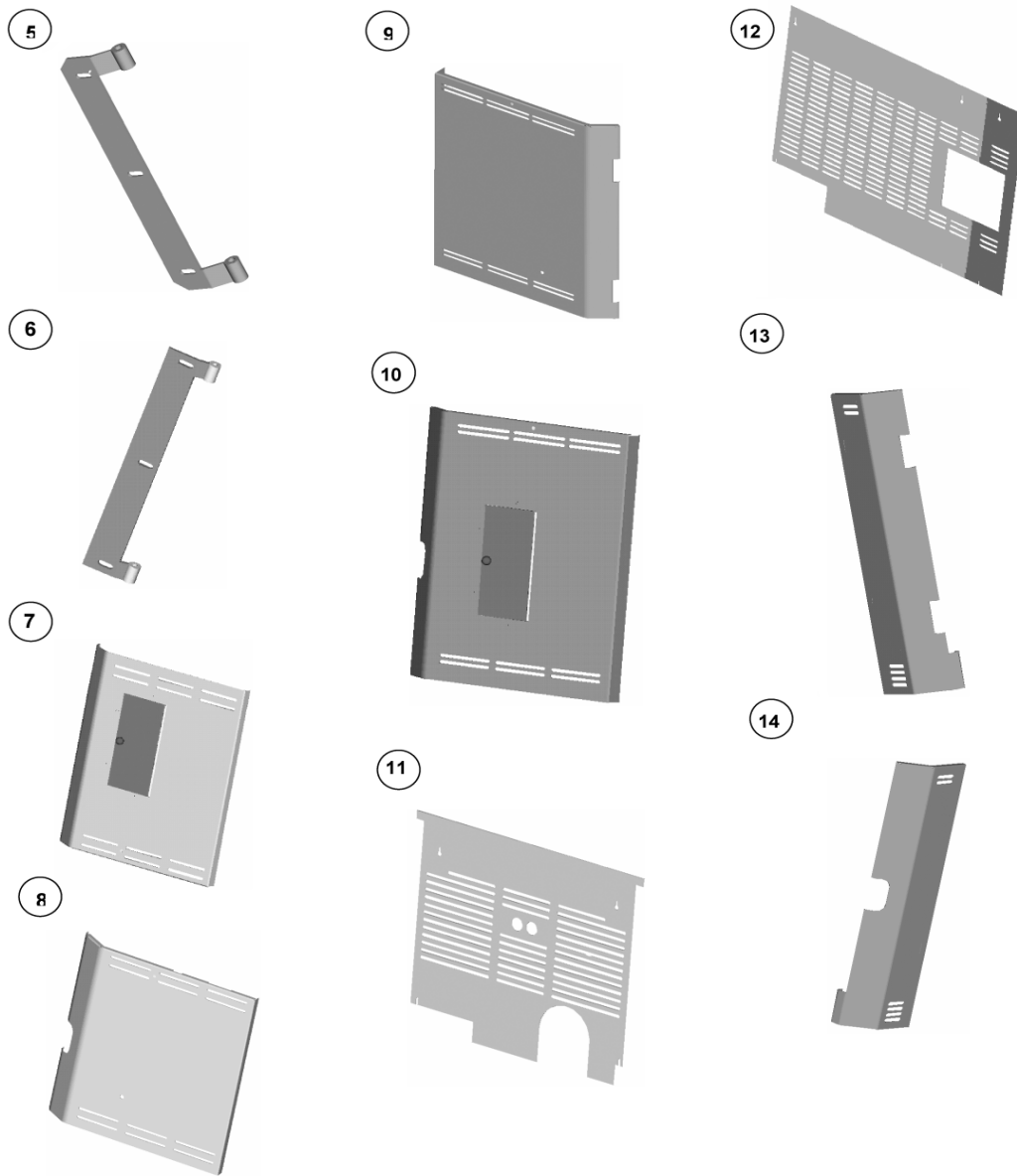

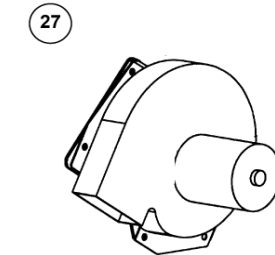
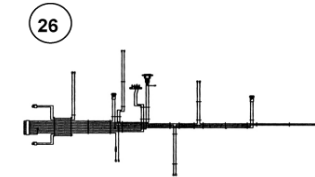
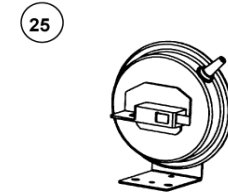
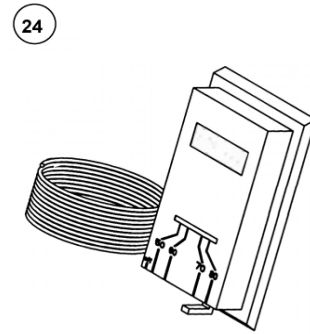
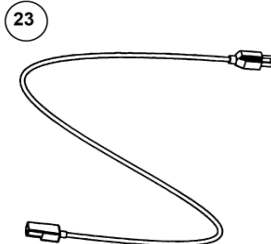
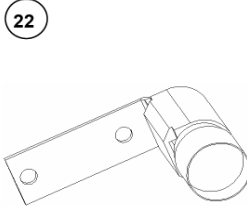
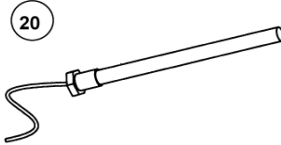
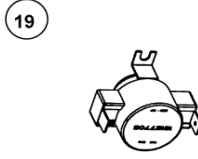
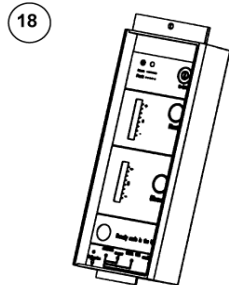
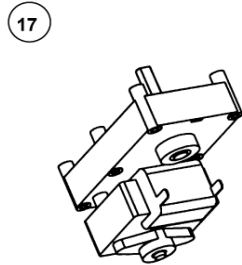
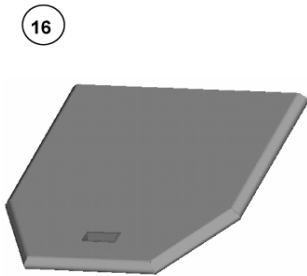
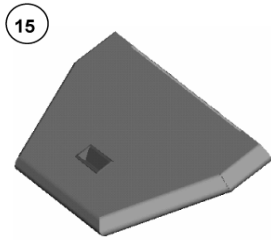

28

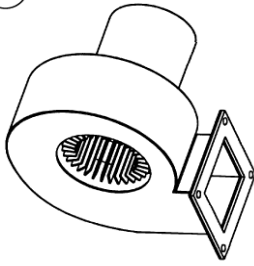

32

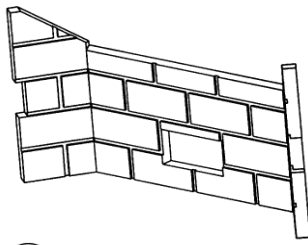

37



29

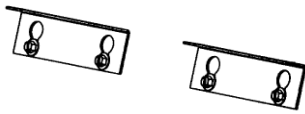

33

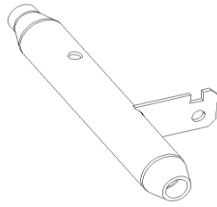

38

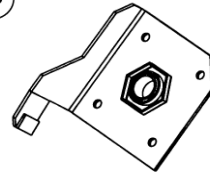

30

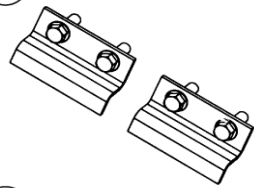

34

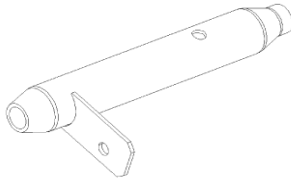

39

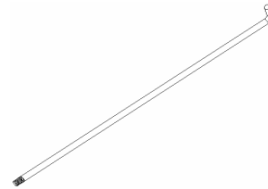

31

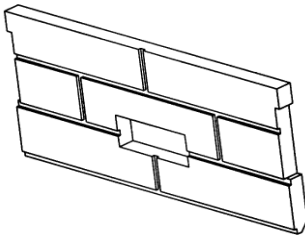

35

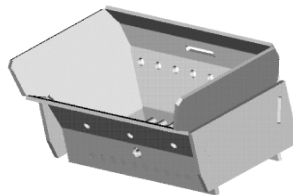

40

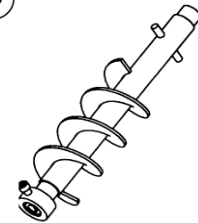

36

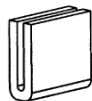

41

